

GENDER IDENTITY AND EXPRESSION AND THE USE OF RESTROOMS ON CAMPUS

PEOPLE MAY USE THE RESTROOM THAT FEELS MOST RIGHT TO THEM

According to federal law, a transgender person cannot be denied access to restrooms used by other individuals of the same gender identity. In 2016, the City of Cleveland signed legislation into law that further affirms the rights of transgender people to choose whichever restroom aligns with their gender identity, even if that differs from the gender assigned to them at birth.

GENDER-INCLUSIVE RESTROOMS

Gender-Inclusive restrooms are used by many transgender and gender diverse people for a variety of reasons. Cleveland State University has over 20 gender-inclusive restrooms on campus. See the complete list, as well as a map of their locations at tinyurl.com/bathroom-map.

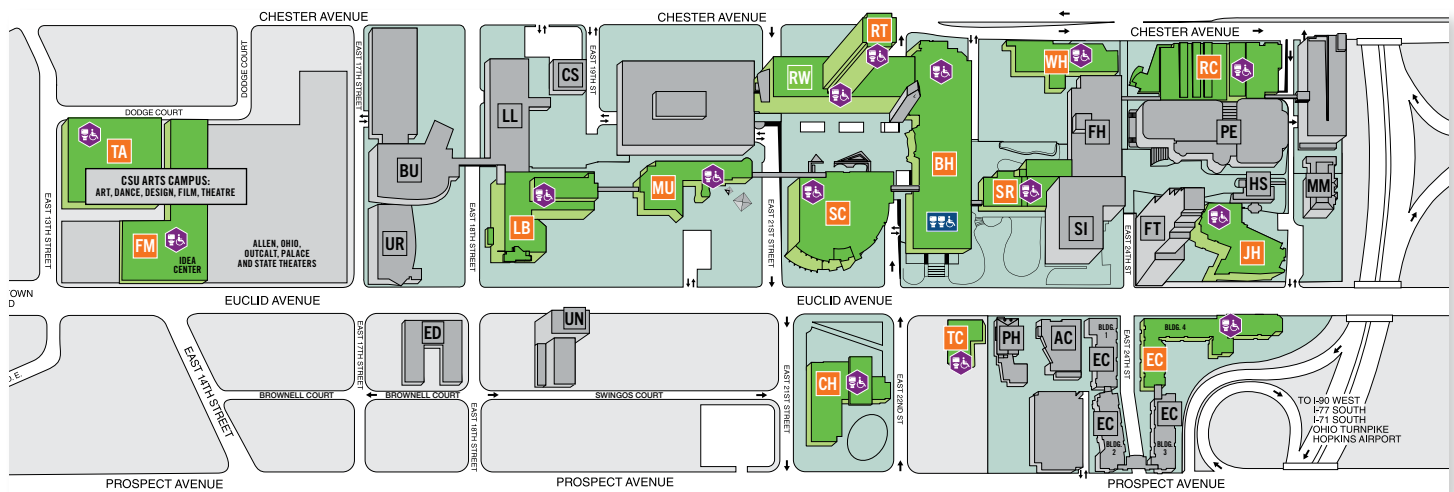

FREQUENTLY ASKED QUESTIONS

Who can use a gender-inclusive restroom?

Gender-inclusive restrooms are open to anyone! These are inclusive spaces for all, including transgender and gender diverse people, cisgender people and families.

Are transgender people required to use gender-inclusive restrooms?

No. In compliance with the law, a transgender person can use the restroom that corresponds with their gender identity. This can include gender-inclusive restrooms or gendered restrooms.

Are gender-inclusive restrooms better for transgender and gender diverse people than gendered restrooms?

Many transgender people use gender-inclusive restrooms to avoid anxiety, dysphoria or harassment they may encounter in a gendered restroom. However, what is best for transgender people is affirming their right to use the restroom that corresponds with their gender identity, including gendered restrooms.

Do gender-inclusive restrooms create additional risk for violence or harassment?

There is no evidence that gender-inclusive restrooms are less safe than gendered restrooms. There have been no reports at Cleveland State University of persons creating unsafe conditions by using the “wrong” restroom.

The law protects individuals from criminal conduct in public restrooms. If you feel that criminal activity is occurring or your safety is threatened while using a campus restroom, you should contact the CSU Police Department at 216-687-2020.

What should I do if I have experienced discrimination or harassment in a University restroom?

CSU’s Policy Against Discrimination, Harassment, Sexual Violence and Retaliation prohibits discrimination and harassment based on gender identity and/or expression. Reports can be made to the Office for Institutional Equity. They can be contacted at oiie@csuohio.edu.

If you feel that there is a threat to your safety, contact the CSU Police Department at 216-687-2020.

What if I have more questions about this policy?

The Office for Institutional Equity is available to answer questions about the restroom policy. They can be contacted at oiie@csuohio.edu.

LGBTQ+ Student Services is available to support transgender and gender diverse students wishing to learn about available support services and other relevant policies. They can be contacted at lgbtq@csuohio.edu.

To learn more about LGBTQ+ inclusive policies and practices, you can sign up for [Safe Space Training](#).